

# CLIP-O-FLEX®

The sturdy rail is made of aluminum which makes it **light, strong, and stylish.**

The flexible clips can easily be positioned in 0/40/80° or 0/45/90° and slide along the rail.

**CLIP-O-FLEX** helps you organize your workspace and saves you valuable time!

## 02 Brand New ! CLIP-O-FLEX

The flexible clip on system

## 04 Components

04 Clip and Rail System | 05 Tray | 06 Accessories

## 07 Complete Systems

Tool Box with CLIP-O-FLEX interface

Product- and Pricelist





# CLIP-O-FLEX®



## WHAT IS CLIP-O-FLEX ?

CLIP-O-FLEX is the most flexible *immersion system* on the market and an absolute world novelty in the field of workplace organization and process optimization. It allows for flexible handling of different working surfaces, classification systems with small parts or tool assortments.

No tools are required for adjusting angles or sliding your trays along the rail.

## YOU CAN USE IT AS

- Prefabricated trays in different sizes, for example in combination with a rigid foam insert.
- Rails and Clips can be ordered individually, which allows you all the flexibility to create a modern workplace to fit your needs.

Trays can be ordered with OPT-I-STORE rigid foam inserts from Metzler.

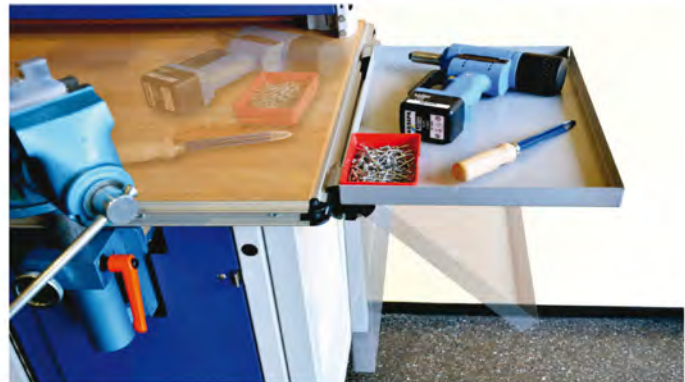

**CLIP-O-FLEX - THE FLEXIBLE CLIP ON SYSTEM**





SOLUTIONS WITH CLIP-O-FLEX®

**INCREASE YOUR PRODUCTIVITY!**

- fast access to your tools and parts
- flexible workplace design
- seamless transfer to multiple workstations
- quickly exchangeable and replaceable
- adaptable for any workspace
- rugged and lightweight aluminum construction
- quick and easy clip system
- practical display with easy access



choose a desired angle - CLIP ON - and you are ready to work!



possible angles are 0/40/80° or 0/45/90°

**RAIL-SYSTEM**

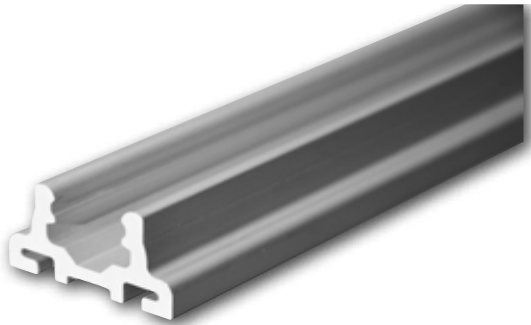
	<b>495</b>	<b>695</b>	<b>745</b>
	Clip on rail, made of aluminum, anodized, cut to length 19 1/2" (495mm) predrilled, incl. covers, incl. mounting material.  Total length, incl. covers + 3/16" (5mm) = 19 11/16" (500mm)	Clip on rail, made of aluminum, anodized, cut to length 27 3/8" (695mm) predrilled, incl. covers, incl. mounting material.  Total length, incl. covers + 3/16" (5mm) = 27 9/16" (700mm)	Clip on rail, made of aluminum, anodized, cut to length 29 11/32" (745mm) predrilled, incl. covers, incl. mounting material.  Total length, incl. covers + 3/16" (5mm) = 27 9/16" (750mm)
	1 piece	1 piece	1 piece
	\$ 28.15	\$ 34.50	\$ 37.40

**Part no. 832-010050 - "sub no."**

sub no.	<b>795</b>	<b>985</b>	<b>1400</b>	<b>1495</b>	<b>1995</b>
	Clip on rail, made of aluminum, anodized, cut to length 31 9/32" (795mm) predrilled, incl. covers, incl. mounting material.  Total length, incl. covers + 3/16" (5mm) = 31 1/2" (800mm)	Clip on rail, made of aluminum, anodized, cut to length 38 3/4" (985mm) predrilled, incl. covers, incl. mounting material.  Total length, incl. covers + 3/16" (5mm) = 38" (990mm)	Clip on rail, made of aluminum, anodized, cut to length 55 1/8" (1400mm) predrilled, incl. covers, incl. mounting material.  Total length, incl. covers + 3/16" (5mm) = 55 3/16" (1405mm)	Clip on rail, made of aluminum, anodized, cut to length 58 7/8" (1495mm) predrilled, incl. covers, incl. mounting material.  Total length, incl. covers + 3/16" (5mm) = 59 1/16" (1500mm)	Clip on rail, made of aluminum, anodized, cut to length 78 9/16" (1995mm) predrilled, incl. covers, incl. mounting material.  Total length, incl. covers + 3/16" (5mm) = 78 3/4" (2000mm)
Package cont.	1 piece	1 piece	1 piece	1 piece	1 piece
Price	\$ 38.20	\$ 44.45	\$ 57.30	\$ 58.90	\$ 71.80

\* Special length upon request

**CLIPS**

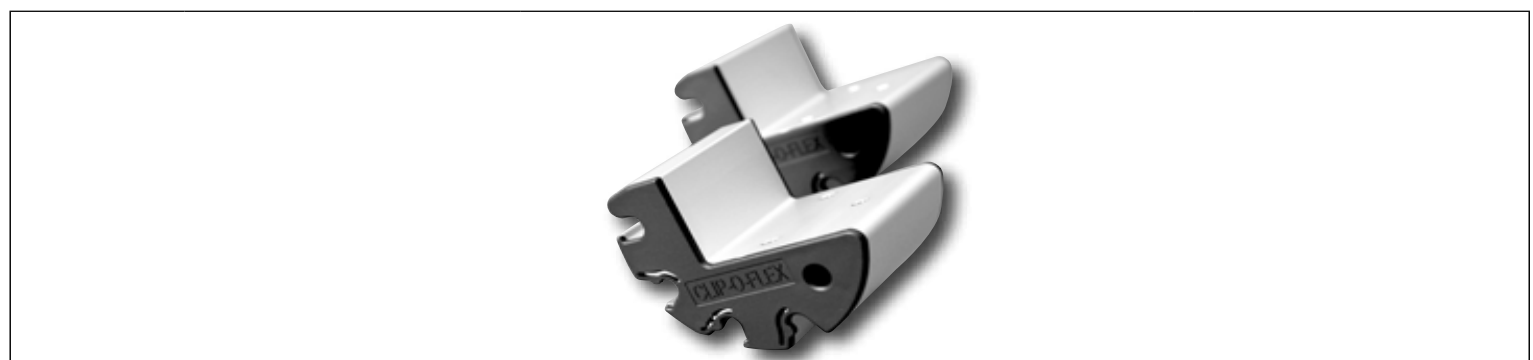

Part no.	<b>832-0101050-50</b>	<b>832-0101051-50</b>	<b>832-0102050-50</b>	<b>832-0102051-50</b>
	Clip 0/40/80 degrees, made of aluminum, anodized, cut to length 2" (50mm) predrilled 4 x Ø 4,1 incl. covers, incl. template.	Clip 0/40/80 degrees, made of aluminum, anodized, cut to length 2" (50mm) 4 x M5 thread incl. covers, incl. template.	Clip 0/45/90 degrees, made of aluminum, anodized, cut to length 2" (50mm) predrilled 4 x Ø 4,1 incl. covers, incl. template.	Clip 0/45/90 degrees, made of aluminum, anodized, cut to length 2" (50mm) 4 x M5 thread incl. covers, incl. template.
Package cont.	2 piece	2 piece	2 piece	2 piece
Price	\$ 41.25	\$ 47.45	\$ 41.25	\$ 47.45



Trays

			
Part no.	<b>832-0301050-520x345x30</b>	<b>832-0302050-520x345x30</b>	<b>832-0301050-345x260x30</b>
	Tray 20 1/2" x 13 9/16" x 1 3/16" (520x345x30mm) RAL 9006 powder coated, steel, incl. 2 Clips 0/40/80 degrees, incl. covers, on the long side of the tray, 20 1/2" (520mm)	Tray 20 1/2" x 13 9/16" x 1 3/16" (520x345x30mm) RAL 9006 powder coated, steel, incl. 2 Clips 0/45/90 degrees, incl. covers, on the long side of the tray, 20 1/2" (520mm)	Tray 10 1/4" x 13 9/16" x 1 3/16" (260x345x30mm) RAL 9006 powder coated, steel , incl. 2 Clips 0/40/80 degree, incl. covers, on the long side of the tray, 13 9/16" (345mm)
Package cont.	1 piece	1 piece	1 piece
Price	\$ 64.00	\$ 64.00	\$ 57.15
			
Part no.	<b>832-0302050-345x260x30</b>	<b>832-0301050-260x345x30</b>	<b>832-0302050-260x345x30</b>
	Tray 10 1/4" x 13 9/16" x 1 3/16" (260x345x30mm) RAL 9006 powder coated, steel, incl. 2 Clips 0/45/90 degrees, incl. covers, on the long side of the tray, 13 9/16" (345mm)	Tray 10 1/4" x 13 9/16" x 1 3/16" (260x345x30mm) RAL 9006 powder coated, steel, incl. 2 Clips 0/40/80 degrees, incl. covers, on the short side of the tray, 10 1/4" (260mm)	Tray 10 1/4" x 13 9/16" x 1 3/16" (260x345x30mm) RAL 9006 powder coated, steel , incl. 2 Clips 0/45/90 degrees, incl. covers, on the short side of the tray, 10 1/4" (260mm)
Package cont.	1 piece	1 piece	1 piece
Price	\$ 57.15	\$ 57.15	\$ 57.15
			
Part no.	<b>832-0301051-150x115x30</b>	<b>832-0301051-210x150x30</b>	<b>832-0301051-320x210x30</b>
	Tray 5 7/8" x 4 1/2" x 1 3/16" (150x115x30mm) with sloped walls, RAL 9006 powder coated, steel, incl. 1 Clip 0/40/80 degrees, incl. covers, on the short side of the tray, 4 1/2" (115mm)	Tray 8 1/4" x 5 7/8" x 1 3/16" (210x150x30mm) with sloped walls, RAL 9006 powder coated, steel, incl. 2 Clips 0/40/80 degrees, incl. covers, on the short side of the tray, 5 7/8" (150mm)	Tray 12 5/8" x 8 1/4" x 1 3/16" (320x210x30mm) with sloped walls, RAL 9006 powder coated, steel, incl. 2 Clips 0/40/80 degrees, incl. covers, on the short side of the tray, 8 1/4" (210mm)
package cont.	1 piece	1 piece	1 piece
Price	\$ 48.15	\$ 50.90	\$ 55.05



**Accessories**

			
Part no.	<b>832-0203000-01</b>	<b>832-0204000-01</b>	<b>832-0700000-10x10xM5</b>
	Corner cap, black, for rail	End cap, black, for rail	Cage nut M5 steel
package cont.	4 piece	10 piece	1 piece
Price	\$ 8.70	\$ 10.90	\$ 0.58

			
Part no.	<b>832-0201000-01</b>	<b>832-0202000-01</b>	<b>832-0205000-01</b>
	Cover, black, for Clips 0/40/80 degrees	Cover, black, for Clips 0/45/90 degrees	Extension for Rail, black
Package cont.	5 pair	5 pair	5 pieces
Price	\$ 11.85	\$ 11.85	\$ 16.40

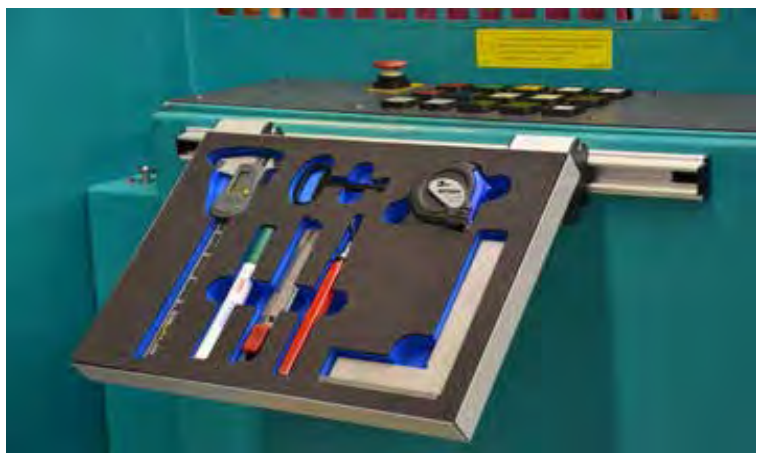

CLIP-O-FLEX Solutions for workplace extensions

# TOOL CART WITH CLIP-O-FLEX INTERFACE

incl. 7 rigid foam inserts and a total of 151 quality tools

*model and scope of delivery*

- Steelframe with solvent resistant plastic worktop
- seven full-extension ball bearing drawers, slide support, carrying capacity 44 lbs. (20 Kg) each drawer, total carrying capacity 662 lbs. (300 Kg)
- this tool cart contains seven rigid foam inserts, equipped with ATORN tools in four drawers.
- four rubber wheels Ø 100 mm, two guide wheels with integrated lock.
- central lock with cylinder lock.
- color: body RAL 7035 light gray, drawers RAL 5010 blue powder coated
- two-tone rigid foam inserts polyethylene (PE) black / blue



Tool Cart includes :  
**three CLIP-O-FLEX rails and two trays**  
 Dimensions 10 3/16" x 13 9/16" x 1 3/16" (260x345x30mm)  
 including Clips 0/40/80 degrees.

Tool Cart with 7 drawers	
height x width x depth	36" x 30 9/16" x 23 1/2"
drawer inside: width x depth	20 3/4" x 13 3/4"
drawer front panel height	6 x 3 3/16" - 1 x 6 1/2"
weight	132 lbs.
<b>Part no.</b>	<b>50 278 575 MG</b>



incl. 151 tools  
 from  
**ATORN®**

Including 7 rigid foam inserts equipped with ATORN tools

sub no.. 509 MG, 515 MG, 516 MG, 517 MG, 526 MG, 530 MG, 590 MG



Various combinations possible



**CLIP-O-FLEX®** is useful in a variety of applications!

The included components can be used as

- 1 storage space at the side of the tool cart
- or as a 2 drawer component.

The shelf dimensions correspond with the included rigid foam inserts. Expand your tool stock and equip empty shelves with additional rigid foam inserts.

Dimensions 10 3/16" x 13 9/16" x 1 3/16" (W/L/H) 260 x 345 x 30 mm

# CLIP-O-FLEX®

**TO ORDER PLEASE CONTACT :**

MTS  
2 Windsor Drive  
Litchfield, NH 03052

1 866 644 2490  
info@multitoolsystems.com  
www.multitoolsystems.com

